

Royal Energy Resources

R·O·Y·E·

Royal Energy Resources, Inc.

Investor Presentation

August 2011



Investor Presentation – Table of Contents

0. Disclaimer

1. 1. About Us

1. 1.1 Company Background
2. 1.2 Company's Business Impressions
3. 1.3 Product- and Investment Portfolio
4. 1.4 Management
5. 1.5 Vision & Mission
6. 1.6 Company's Philosophy & Market Indicators

1. 2. Business Model

1. 2.1 Operations - Strategy & Objectives
2. 2.2 Target Markets (Oil and U.S. / Romania)

Investor Presentation - Table of Contents

3. Growth Strategy

4. Financial Data

4.1 Stock Information and Development

4.2 Financial Results for the last 3 quarters (per May 2011)

4.3 Revenue Projections 2011-2015

5. Investment Perspectives

6. Contact

0. Disclaimer

- *This document does not constitute an offering document. Potential investors or shareholders should not rely on the information contained in this document before making an investment decision. Certain of the information contained in this investor presentation may contain “forward looking information”. Forward-looking information and statements may include, among others, statements regarding the future plans, costs, objectives or performance of Royal Energy Resources, Inc. (the “Company”), or the assumptions underlying any of the foregoing. In this presentation, words such as “may”, “would”, “could”, “will”, “likely”, “believe”, “expect”, “anticipate”, “intend”, “plan”, “estimate” and similar words and the negative form thereof are used to identify forward-looking statements.*
- *Forward-looking statements should not be read as guarantees of future performance or results, and will not necessarily be accurate indications of whether, or the times at or by which, such future performance will be achieved. Forward-looking statements and information are based on information available at the time and/or management’s good-faith belief with respect to future events and are subject to known or unknown risks, uncertainties, assumptions and other unpredictable factors, many of which are beyond the Company’s control. These risks, uncertainties and assumptions include, but are not limited to, those described under “Risk Factors” in the Company’s annual information form (for details please review the Company SEC Filings on the U.S. Securities and Exchange Commission website) and could cause actual events or results to differ materially from those projected in any forward-looking statements. The Company does not intend, nor does the Company undertake any obligation, to update or revise any forward-looking information or statements contained in this presentation to reflect subsequent information, events or circumstances or otherwise, except if required by applicable laws.*



1. About Us

1.1 Company Background

- **Royal Energy Resources, Inc. (based in New York) is a development stage Company which focuses primarily on energy projects in the United States of America. The Company is enhancing its activities to further countries like Romania. Per now the Company is forming a subsidiary for the planned acquisition and mining development of valuable rare earth materials like gold, silver and copper. The subsidiary named S.C. Golden Carpathan Resources will be located in Bucharest.**
- **As of August 2010 the Company has interests in oil and gas leases and holds leases comprising 3,400 acres of property in Wyoming. Furthermore the Company holds a lease for uranium rights comprising 1,600 acres in Laramie County, Wyoming. The Company also holds the lease for 3,410 acres of rare earth and precious metals in Crook County, Wyoming.**

The Company's aim: Royal Energy Resources, Inc., (in the following also ROYE) was originally founded in 1999 with another scope of business. Today it is a public traded Company on the OTCBB market (R.O.Y.E.) and plans to be an emerging player in the gold and silver business. Oil- and gas royalties, as well as uranium and rare earth materials are a business scope in the near future.

1. About Us

1.2 Company's Business Impressions

- **Royal Energy Resources, Inc. has acquired 3,110 acres of mineral leases (in yellow on the map). These mineral leases lie between 4 and 12 miles away from Rare Element Resources Ltd.'s Bull Hill prospect (here shown in blue) and Bearlodge Mountain in Sundance Wyoming.**
 - **Business perspective: The Company is planning to request a permit for drilling testing from the Wyoming Department of Environmental Quality (WDEQ)/Land Quality Division (LQD) – Exploration Drilling and Mine in the next few month.**
- An indicator for the value of this area: Rare Element Resources Ltd. is another owner of mineral leases close to ROYE's area estimates approximately 15 million tons of rare earth minerals in their mining section.**

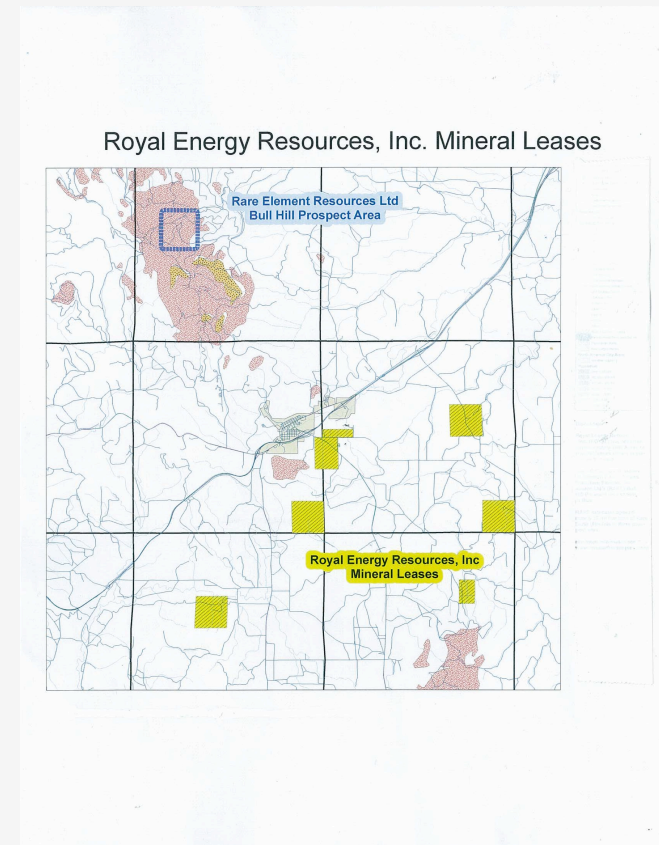

1. About Us

1.2 Company's Business Impressions

Rare earth metals in Crook County are close, app. 5-6 miles from Bear Lodge Mountain. The US geological survey has studied the area of Bear Lodge Mountain extensively (USGS Prof. paper # 1049 –D) and has estimated that it contains one of the largest deposits of disseminated rare earth elements in North America.

Another indicator for the value of Royal Energy Resources, Inc.'s leases: Powertech Uranium Corp. based in Vancouver, British Columbia, Canada has proposed a \$20,000,000 uranium mine in Weld County, CO. The permit is currently in the process for approval. At a current price the uranium would be worth over \$500 million.

ROYE has 1,600 acres in Laramie County, Wyoming. The property is close to the well-known uranium mine.

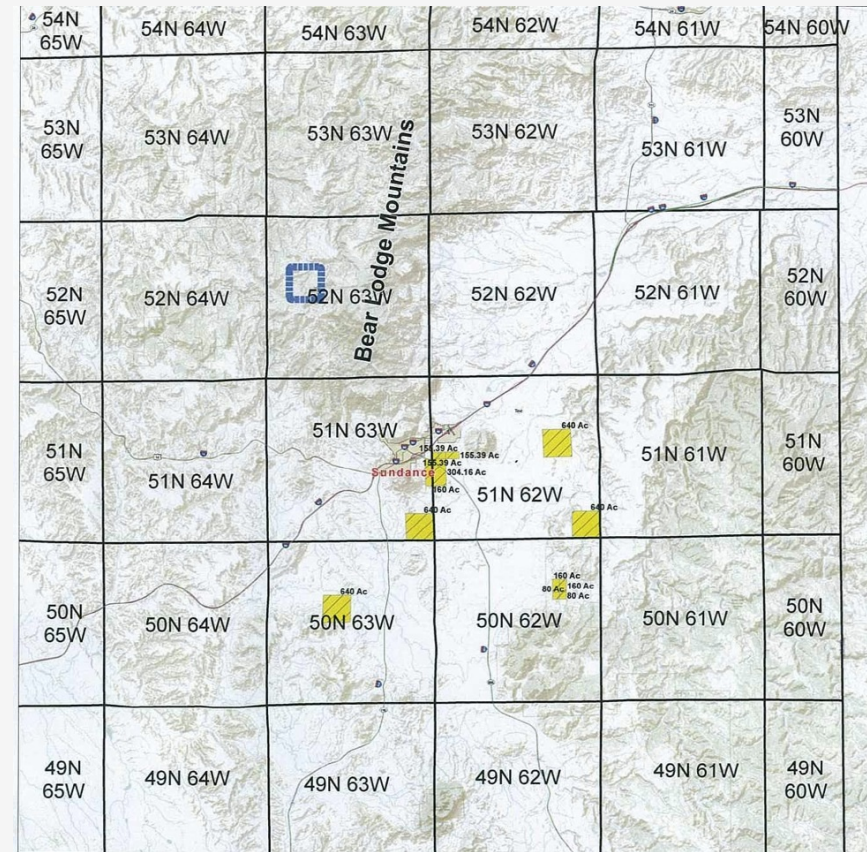



1. About Us

1.3 Product- and Investment Portfolio

- **The Company was the successful bidder in the U.S. Government auctions to purchase certain oil- and gas leases rights. The oil and gas leases currently represent app. 3,000 acres of property located in Weston, Goshen, Converse, Fremont, Laramie and Platt County Wyoming.**
- **The Company also holds leases for uranium rights on app. 1,000 acres in Wyoming. ROYE is negotiating with energy companies to develop the potential resources that may be contained in these properties.**
- **The management has completed several transactions wherein the Company sold the leases rights and retained a royalty interest in one transaction. No exploration activities have yet taken place. This will be a planned step for the future. The Company has received proceeds of \$70,275 from these transactions (for further details please see 10Q fillings).**

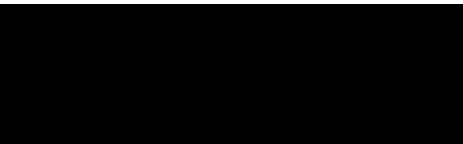
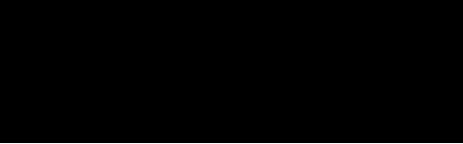

1. About Us

1.3 Product- and Investment Portfolio

Business field oil & gas	Business field rare earth materials and metals
3,000 and 6,000 acres in Weston, Goshen, Converse, Freemont, Laramie and Platt County Wyoming	1,000 acres in Wyoming for uranium Future activities in Romania for precious metals as in example gold, silver and copper



1. About Us

1.4 Management

Jacob Roth, Chief Executive Officer, Chief Financial Officer and President

Jacob Roth is in charge of these functions for Royal Energy Resources, Inc. since March 1999.

He has fifteen years of experience as a financial controller with various public companies. From 1973 to 1980 he helped to raise funds for oil and gas development stage companies.

He was the CEO of Virilitec Industries, Inc. a public company engaged in attempting to distribute a line of bioengineered virility nutritional supplements. Previously he was the President of JR Consulting, also a public company engaged in consulting for other corporations.



1. About Us

1.4 Management

Richard W. Miller, Treasure Resources, Inc.

Richard Miller works as a consultant for the oil and gas industry. He has gathered fundamental market experience while working for Hunt Energy Corporation for two years and for five years he was responsible for the merger & acquisition Group of Exxon Corporation with responsibility for checking all titles (fee, federal, state and company records) for the acquisitions.

He has been the owner and president of Reliant Energy, Inc. and worked for Hunt Energy Corporation as further activities contributing to his extensive market knowledge and business know-how.



1. About Us

1.5 Vision & Mission

- **Our mission is to become an emerging relevant player in the business of oil and gas royalties, as well as uranium and rare earth materials in the near future.**
- **We rely on our skills with many years of experience and a grown network in the industry.**
- **Royal Energy Resources, Inc. will be a driving partner in the development of oil & gas mining in the U.S. with ambitious expansion into other interesting countries with rare and valuable resources in the earth.**

1. About Us

1.6 Company's Philosophy & Market Indicators

Market development in the relevant business fields:

Commodities	US Dollar	Changes in %
Oil Brent / per barrel	117,50	+ 25,1
Oil WTI / per barrel	99,24	+ 8,4
Gold / per troy ounce	1.615,29	+ 14,2
Silver / per troy ounce	40,76	+ 33,2
Copper / per troy ounce	9.679,00	+ 0,4

Source: Platow Brief Rohstoffe (own research per 25.07.11)

Source: Royal Energy Resources, Inc.

Slide 13



1. About Us

1.6 Company's Philosophy & Market Indicators

- **America's oil and natural gas companies have invested over \$1 Trillion in long-term energy initiatives between 1992 and 2009. Energy Independence is an achievable goal for the U.S..**
- **ROYE brings clean, home-grown energy to our nation – a contribution for truly breaking us from foreign oil import. The management is focused on exploration and mining business in stable and emerging markets with steady growth potential for oil, gas and rare earth elements with ongoing market demand and future perspective.**



2. Business Model

2.1 Operations - Strategy & Objectives

- **Our business model is focused on the acquisition of leases for promising properties.**
- **There are two options: Either own development of the properties with research and mining concessions or collection of the royalties as a business model which is generation fast revenues without high or long term investments in properties.**

The Company is currently pursuing gold, silver, copper and rare earth metals mining concessions in Romania, Bulgaria and Canada and mining leases in the United States. If successful, the Company plans to concentrate its efforts to develop these properties. During the three month period ended May 31, 2011, the Company acquired app. 2,770 acres of rare earth and precious metal leases in Crook County Wyoming.



2. Business Model

2.2 Target Market - Oil

- „OPEC crude oil production, as per secondary sources, increased by 520,000 barrels per day in 2010 compared to the previous year, to average 29,23 million barrels per day (2% increase)....
- NON-OPEC supply
- In 2010, non-OPEC supply experienced a strong growth of 1,12 million b/d compared to the previous year. The growth was supported by increase in crude, non-conventional oil, bio fuels and natural gas liquid (NGL) production. Both conventional and non-conventional productions supported the growth of the non-OPEC supply equally.

The output increase was the highest since 2002 and was supported mainly by supply growth in the U.S., China, Russia, Brazil, Canada and Columbia.... U.S. oil supply achieved the highest growth in 2010 compared with all non-OPEC countries.“

Source: Annual Report 2010_ OPEC

Source: Royal Energy Resources, Inc.

Slide 16



2. Business Model

2.2 Target Markets – U.S. / Romania

The activities and operations in the U.S. have been initiated as Mr. Roth was involved in raising capital as a consultant 25 years ago and generated a profound market knowledge during several years.

ROYE's expansion into other markets as Romania, with local presence and mining activities is based on the potential the area is offering. The Company is advised by a law firm providing excellent standing and local relations.

Romania has a long history in this respect. 500 years ago rich deposits and resources of gold and silver have been found.

Other companies are present in Romania. Gabriel Resources Ltd. (listed on the Toronto Stock Exchange) just received concessions for mining. European Gold Fields Ltd., also listed at Toronto Stock Exchange has a subsidiary in Romania.

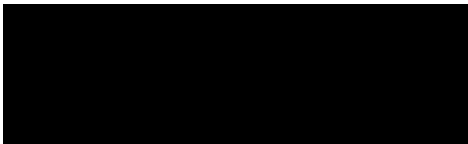
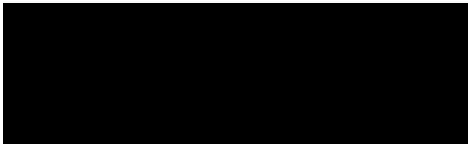

2. Business Modell

2.2 Traget Market Oil

OPEC Basket Price

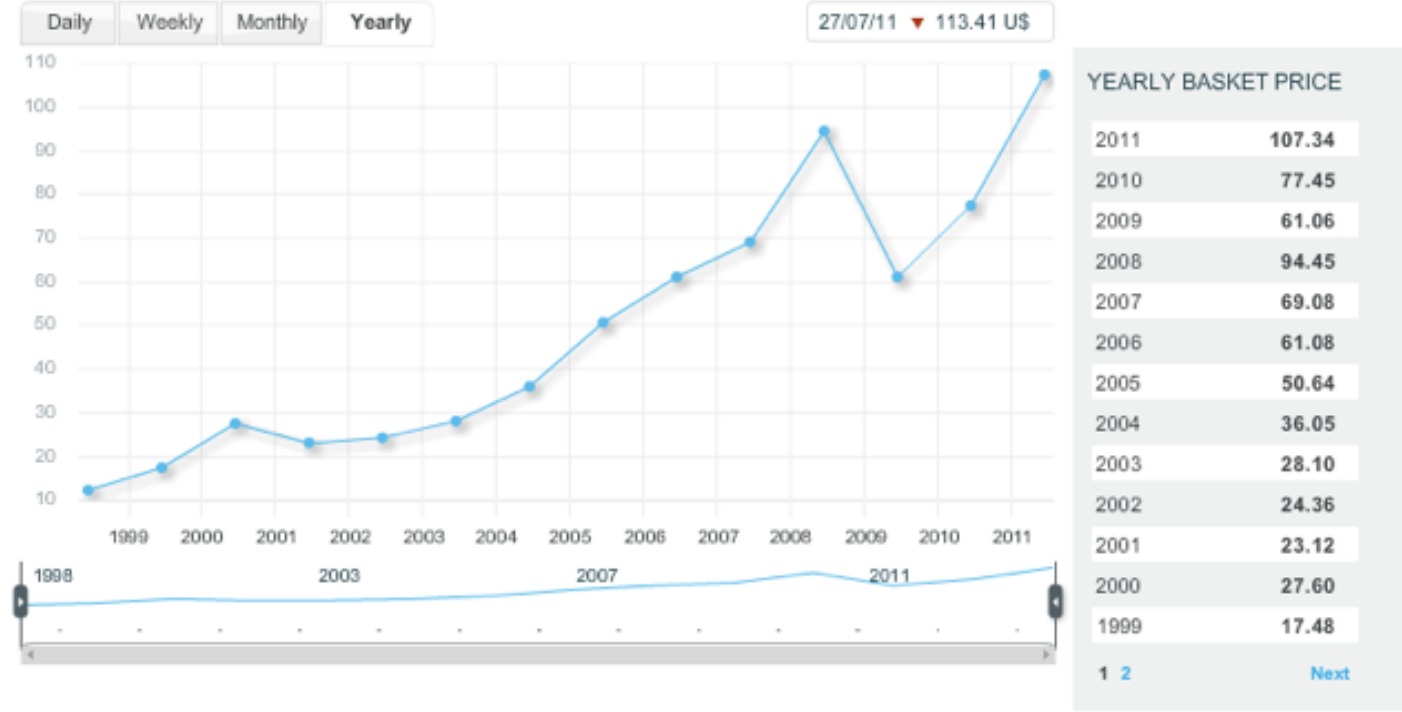

Source: OPEC

Source: Royal Energy Resources, Inc.



3. Growth Strategy

Potential and measures

- **The Company is generating its growth through the collection of royalties from the owned leases and own realization of shallow drilling in the properties.**

The Company is currently attempting to secure financing in Europe of \$5 to \$10 million during the next eighteen months. This funding would be used primarily for development of rare earth- and precious metal leases in the United States and Eastern Europe, for purchase of Energy and mining leases and other corporate requirements for the ongoing Company development.

The strategy to generate the most profits out of the royalties is a proven success model as companies like Royal Gold, Inc. demonstrate successfully.

On the other hand the investments are relatively low. In the first step ROYE is making a small profit by selling the property and long term- as a second phase - the Company is benefitting from the royalties in conjunction with mining activities.

4. Financial Data

4.1 Stock Information and Development



Share structure: app. 85 Million outstanding; authorized app. 100 Mio.; free trading 39 Mio.

Source for this chart: <http://finance.yahoo.com/echarts?s=ROYE.OB>

Source: Royal Energy Resources, Inc.

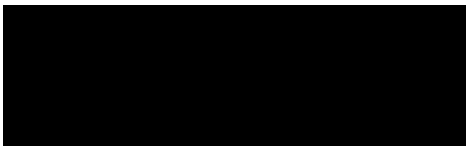

4. Financial Data

4.2 Results for the past 3 quarters (per May 2011)

- Per today the Companies owns app. 7,800 acres for oil and gas mining ,reflecting a ground value of estimated \$200-300 per acre.

- Results:

Net loss	\$ (187,953)	
Interest	5,884	
EBIDA	\$ (182,069)	



4. Financial Data

4.2 Revenue Projections for 2012-2015

2012: \$400.000 2013: \$600.000 2014: \$700.000 2015: \$800.000

These figures are forward looking projections based on the Company getting the planned funding of \$10.000.000 to finance the planned growth- and expansion strategies.

It is impossible to give an accurate prediction of such dynamic markets as there are many global influencing factors. For example the financial crisis had a positive effect on the gold market. In 2011 China is buying gold as a hedge against inflation. Due to public debt and the FED's monetary policy, private investors in the U.S. are focusing on gold as a hedge against inflation and volatile stock markets. On the other hand market demand can decrease out of a sudden too. It is not possible for ROYE's management to anticipate the global development regarding politics, crisis and trends in the economy. But in general gold and rare earth elements are in demand right now.



5. Investment Perspective

Reasons to Invest

- **“U.S. oil price increases over 100 US-Dollar mark. The price for WTI oil was climbing to its highest level since 6 weeks with a plus of 1,8% ...” (Handelsblatt 21th of July 2011)**
- **“U.S. oil and natural gas rig count increases by 1 this week. Washington Post reports that the number of U.S. rigs exploring for oil and natural gas climbed by one this week to a total of 1,887.” (Washington Post 08th of July 2011)**

Royal Energy Resources, Inc. (OTCBB R.O.Y.E.) represents an emerging player in oil & gas- and uranium royalties in the U.S. and is enhancing this impact to gold and silver reserves in Romania. These activities could unlock significant value for shareholders.

Royal Energy Resources is an emerging Company in the U.S. working to sustain tomorrows energy resources and availability. ROYE is also an investment in United States of America’s future.

5. Investment Perspective

Reasons to invest

“It is our major intention to seek out attractive oil and gas mineral rights royalty interests and working with experienced partners to develop the properties in the most valuable way. I believe that our general approach, investing not much to get the rights in the first line and generate attractive revenues later out of the sold royalties is a win-win model and also securing the investors a careful method to work with this capital.”

(Jacob Roth, Chief Executive Officer, Chief Financial Officer and President of Royal Energy Resources, Inc.)



6. Contact

Investor Relations

- **Royal Energy Resources, Inc.**
- **Mr. Jacob Roth**
- **543 Bedford Ave. #175
BK New York 11211**

- **Phone:**
- **800-620-3029 (in the U.S.)**
- **+1 718.3875331**
- **Email:**
roye177@aol.com

